

WMP

VIDEO MOUNT PRODUCTS

Instruction Sheet For:

LCD-MID-C & LCD-MID-CB

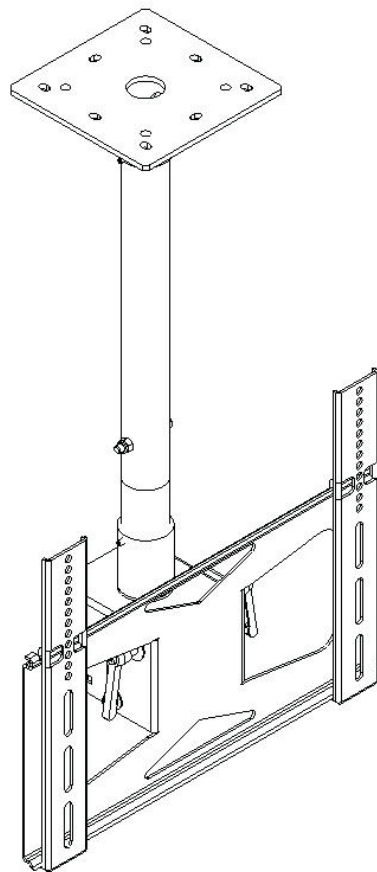

For more information, please contact us at:
345 Log Canoe Circle, Stevensville, Maryland 21666
Toll Free: 877.281.2169 Phone: 410.643.6390 Fax: 410.643.6615
www.videomount.com

LCD-MID-C

ITEM NO.	DESCRIPTION	QTY.
1	Ceiling Plate	1
2	Outer Mast	1
3	Inner Mast	1
4	Pipe Couple	1
5	Washer $\phi 1.7$ * $\phi 55.6$ *T3.0	2
6	Nylon Nut M16*P2.0	1
7	Base Plate	1
8	Tilt Plate	1
9	Screen Mounting Brackets	2
10	Screw 5/16" - 18UNC*L2.5"	1
11	Nylon Nut 5/16" - 18UNC	1
12	Screw M8*P1.25*L20	4
13	Nylon Washer $\phi 12.5$ * $\phi 30$ *T1.8	4
14	Washer $\phi 8.5$ * $\phi 25$ *T2.0	2
15	Washer $\phi 5/16$ "* $\phi 19$ *T1.6	2
16	Gear Nut	2
17	Lever Handle	2
18	Lever Screw	2
19	Brake Screw 1/4" - 20UNC*L3/8"	2
20	M3 Allen Key	1
21	Security Screw M5*P0.8*L20	2
22	Long Allen Key M4	1
23	Screw M4*P0.7*L12	4
24	Screw M5*P0.8*L12	4
25	Screw M6*P1.0*L12	4
26	Screw M8*P1.25*L16.5	4
27	Screw M4*P0.7*L30	4
28	Screw M5*P0.8*L30	4
29	Screw M6*P1.0*L35	4
30	Screw M8*P1.25*L40	4
31	Lock Washer M4	4
32	Lock Washer M5	4
33	Lock Washer M6	4
34	Lock Washer M8	4
35	Washer $\phi 5.5$ * $\phi 18$ *T2.0	4
36	Spacer M6	4
37	Spacer M8	4
38	PVC Washer $\phi 16.5$ * $\phi 55.6$ *T0.7	2
39	Cotter Pin	1
40	Lag Screw 5/16" *L2.5"	4
41	Washer $\phi 8.3$ * $\phi 19$ *T1.6	4
42	Nylon Nut M8*P1.25	2

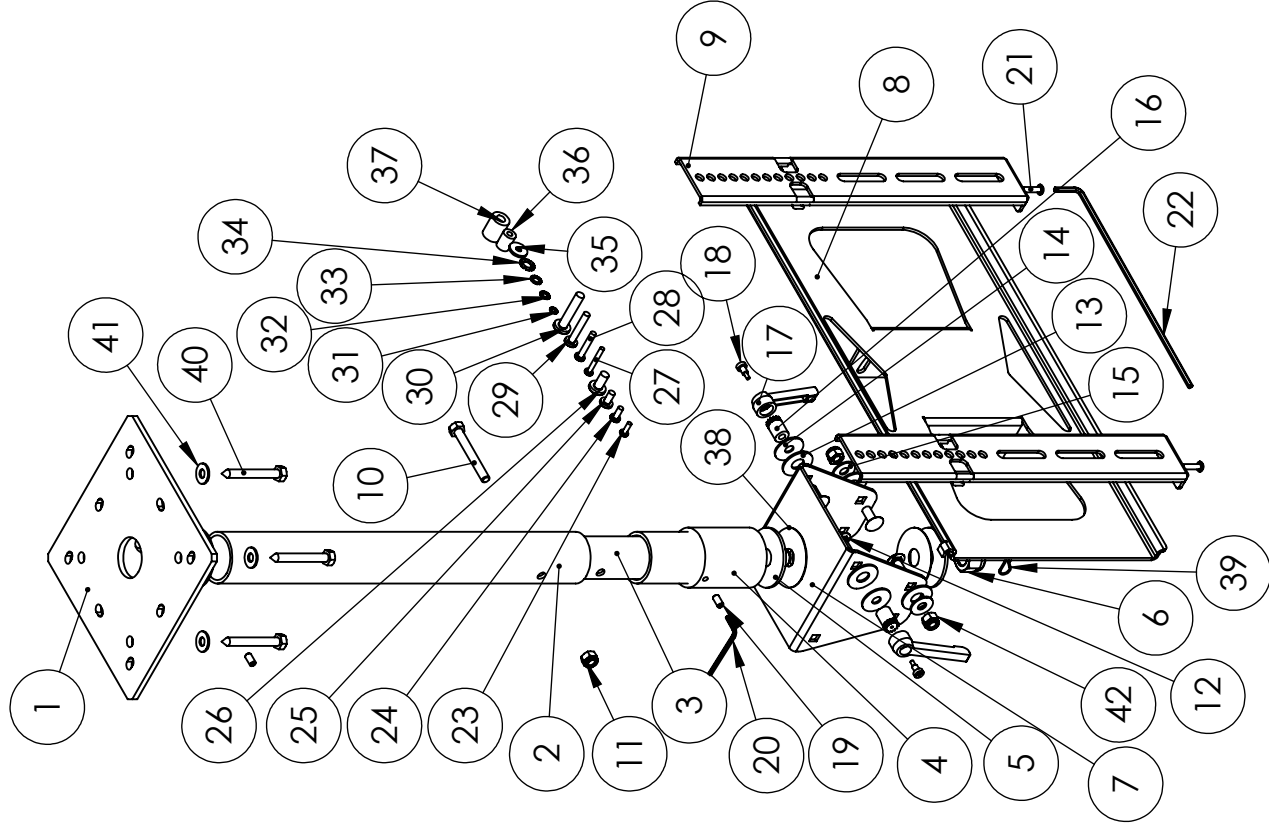

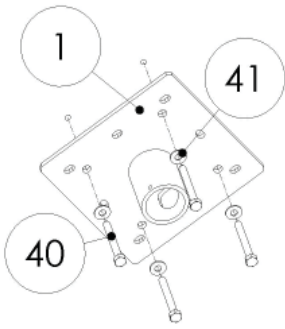

Step 2 : Mounting the ceiling plate

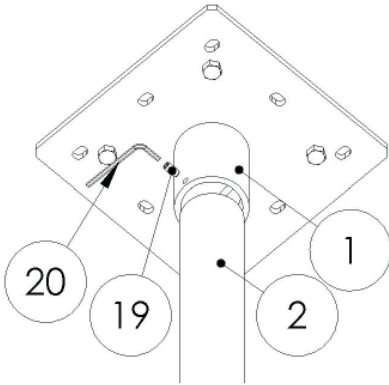

Step 3: Attaching the outer mast

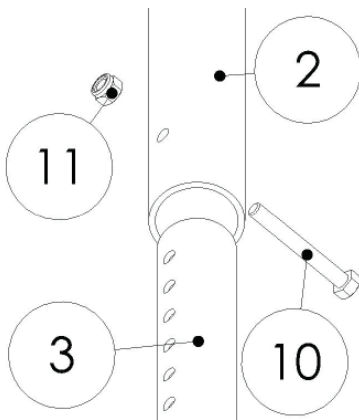

Step 4 : Attaching the inner mast

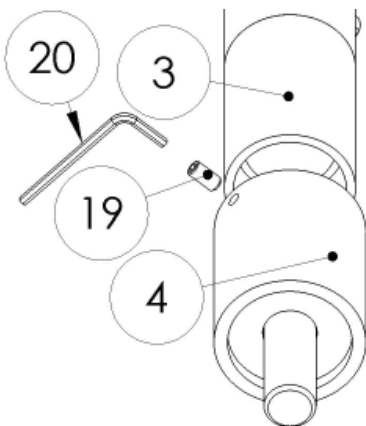

Step 5 : Attaching the pipe couple

Step 1

Before starting, lay out all parts to your mount and match them to the parts list provided. Verify that you have all your parts before attempting to assemble the mount.

Step 2

Mark the ceiling or desired mounting surface in preparation of installation of ceiling plate (1). If mounting to wooden ceiling joists, pre drill pilot holes using a 7/32" drill bit. Attach the ceiling plate (1) to the wooden ceiling joist using the 5/16" by 2.5" long lag screw (40) and washer (41). **WARNING: Please verify that your mounting surface will support the combined weight of your mount, mounting hardware, and flat panel. Also verify that the mounting surface is safe to drill through. Please note only mounting hardware for mounting to wooden ceiling joists will be provided with the unit. If mounting to a surface other than wooden ceiling joists then other hardware will be required. If in doubt or uncertain about any of the above, please contact a professional installer.**

Step 3

Screw the outer mast (2) into the ceiling plate (1) as tight as possible. Then proceed to take the 1/4" - 20 brake screw (19) tighten it down into the pipe couple on the ceiling plate (1) using the M3 Allen key (20). **Note: It is important to tighten down the brake screw (19) as far a possible to prevent the outer mast (2) from rotating out of the pipe couple on the ceiling plate (1).**

Step 4

Insert the inner mast (3) into the outer mast (2) and pin the inner mast into place at the desired height using the 5/16" by 2.5" long hex head screw (10) and nylon nut (11).

Step 5

Screw the pipe couple (4) onto the inner mast (3) as tight as possible. Then tighten the 1/4" - 20 brake screw (19) into the pipe couple using the M3 Allen Key (20). **Note: It is important to tighten down the brake screw (4) as far a possible to prevent the pipe couple (19) from rotating off of the inner mast (3).**

Step 6

Attach the base plate (7) to the pipe couple (4) using the large washers (5) PVC washers (38) and M16 nylon nut (6). Once the nylon nut (6) is tight, slide the cotter pin (39) through the small hole near the bottom of the screw coming out of the pipe couple (4). **Note: Be sure to tighten down the nylon nut (6) as far as possible to prevent sag or list in the mount.**

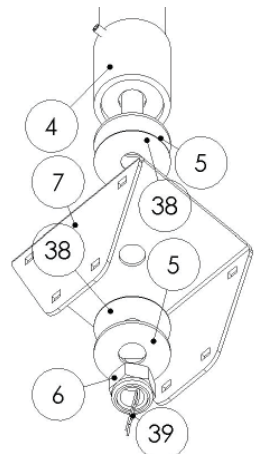

Step 6 : Attaching the base plate

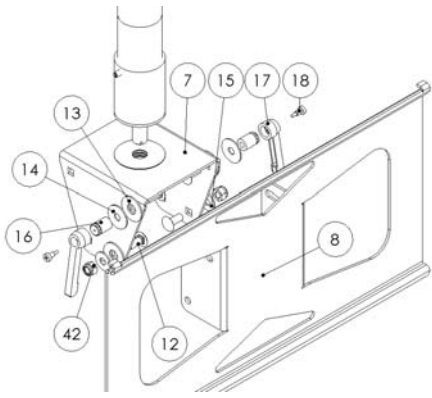

Step 7 : Attaching the tilt plate

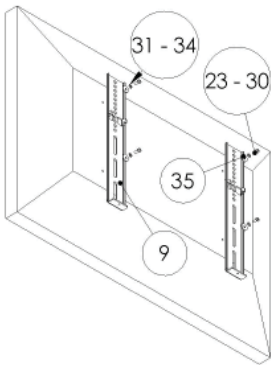

Step 8A : Attaching the mounting brackets to the screen (spacers not needed)

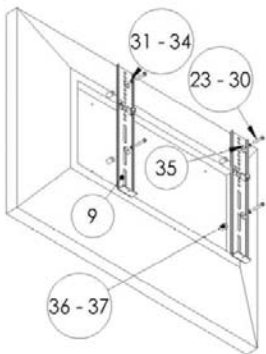

Step 8B : Attaching the mounting brackets to the screen (spacers used due to recessed hole patterns)

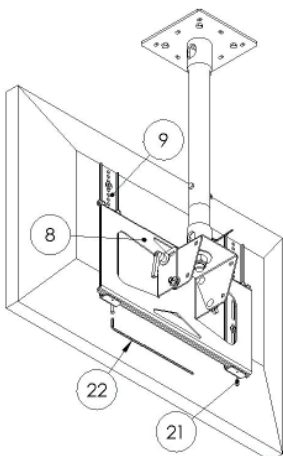

Step 9 : Attaching the mounting brackets to the tilt plate

Step 7

Attach the tilt plate (8) to the base plate (7) by first inserting plastic washers (13) in between the base plate and tilt plate on each side. Then insert the 5/16" by 3/4" long square neck screws (12) into the base plate (7) so the screws are pointed outwards. On the bottom screws on each side secure the screws with the 19 mm outer diameter washers (15) and nylon nuts (42). On the upper screws place the 25 mm outer diameter washers (14) and use the gear nuts (16), lever handle (17) and lever screw (18) to secure the tilt plate's (8) position. Tilt the tilt plate (8) as far up as it will go and lock the tilt into place by tightening down the lever handle (17) as far as it will go on each side. **Note: This is important to do to allow step 9 to be accomplished safely and easily.**

Step 8

Determine the correct screw size and if you need to use washers, lock washers, or spacers. **Note: Spacers are used for TVs with recessed hole patterns.** Secure the display to the screen mounting brackets (9) using the appropriate hardware (23) through (37). **Note: The brackets have to be level with each other to work properly.**

Step 9

Make sure the tilt plate (8) is locked into place by tightening down the lever handles (17) as far as they will go. Lift the screen mounting brackets (9) with the attached flat panel onto the tilt plate (8). Then while another person is holding the flat screen in place tighten down the security screws (21) as far as they will go with the long Allen key (22) to lock the screen mounting brackets (9) into place. Once the screen mounting brackets (9) are secure then you can adjust the tilt by loosening the lever handles (17) and adjusting the tilt plate (8) to the desired position and then retightening the lever handles (17) once it is in position.

Please verify that all nuts and screws are securely tightened.



Enjoy Your Mount!

WARNING: The installer of these products must verify that the mount surface, ceiling or wall, will safely support the combined weight of all attached equipment and hardware. Video Mount Products will not be held liable for the improper use or installation of its products.